

HLSE A SERIES

Linear Luminaires

WAC ARCHITECTURAL

PROJECT:

TYPE:

Product Image



Line Drawing

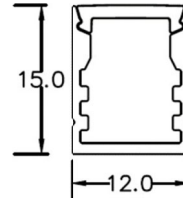

Product Description

HLSE-A1 line light, width 12mm, height 15mm, uniform light output without light spots, Ra>90, with high color reproduction, double-ended bottom quick connector, easy to use with mounting clips. It is specially designed for indoor places such as small dark grooves, hook edge decoration, and luminous ceilings, and is suitable for hotel villas, commercial spaces, public venues and other places.

Product Features

- Main Material: Flexible copper FPCB board, high quality aluminum material, PC shade
- IP Rating: IP20
- Operating Temperature: -20°C~50°C

Product Specifications

- LED Type: SMD
- Source Power: 6W/M, 10W/M
- LED Lifetime: >36000h-L70 /B10-Ta25°C(LM-80/TM-21)
- CCT/CRI: 2700K/3000K/4000K , Ra90
- Input: 24V DC
- Dimming: 0-10V / DALI

Order Model

Model	LE D	Length	CR I	CC T	Series	Finish
HLSE Hard strip light	06 6W/M 10 10W/M	10 1010mm	9 90	27 2700K 30 3000K 40 4000K	A1 Width: 12mm Height: 15mm	SG

Example: HLSE-0610-927A1SG

* Only white light specifications are supported, and the wires come out of the bottom quick connector

* For additional power, color temperature and length, please consult WAC

Accessories

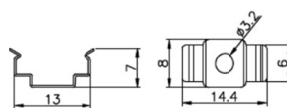

Dedicated fixed fixtures for the A1 series
2pcs/meter is included by default

HLSE A SERIES

Linear Luminaires

WAC ARCHITECTURAL

PROJECT:

TYPE:

Product Image



Line Drawing

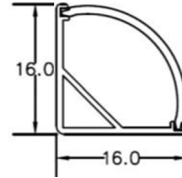

Product Description

HLSE-A2 line light, width 16mm, height 16mm, light on fan-shaped surface, uniform light output without light spots, Ra>90, with high color reproduction, double-ended bottom quick connector, easy and quick to use with mounting clips. It is specially designed for indoor places such as small dark grooves, hook edge decoration, and luminous ceilings, and is suitable for hotel villas, commercial spaces, public venues and other places.

Product Features

- Main Material: Flexible copper FPCB board, high quality aluminum material, PC shade
- IP Rating: IP20
- Operating Temperature: -20°C~50°C

Product Specifications

- LED Type: SMD
- Source Power: 6W/M, 10W/M, 13W/M
- LED Lifetime: >36000h-L70 /B10-Ta25°C(LM-80/TM-21)
- CCT/CRI: 2700K/3000K/4000K , Ra90
- Input: 24V DC
- Dimming: 0-10V / DALI

Order Model

Model	LED	Length	CR	CC	Series	Finish
	D		I	T		
HLSE Hard strip light	06 6W/M	10 1010mm	9 90	27 2700K	A2 Width: 16mm Height: 16mm Light on fan-shaped surface	SG
	10 10W/M			30 3000K		
	13 13W/M			40 4000K		

Example: HLSE-0610-927A2SG

* Only white light specifications are supported, and the wires come out of the bottom quick connector

* For additional power, color temperature and length, please consult WAC

Accessories

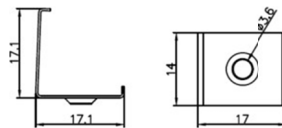

Dedicated fixed fixtures for the A2 series
2pcs/meter is included by default

HLSE A SERIES

Linear Luminaires

WAC ARCHITECTURAL

PROJECT:

TYPE:

Product Image



Line Drawing

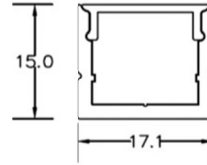

Product Description

HLSE-A1 line light, width 17mm, height 15mm, uniform light output without light spots, Ra>90, with high color reproduction, double-ended bottom quick connector, easy to use with mounting clips. It is specially designed for indoor places such as small dark grooves, hook edge decoration, and luminous ceilings, and is suitable for hotel villas, commercial spaces, public venues and other places.

Product Features

- Main Material: Flexible copper FPCB board, high quality aluminum material, PC shade
- IP Rating: IP20
- Operating Temperature: -20°C~50°C

Product Specifications

- LED Type: SMD
- Source Power: 6W/M, 10W/M, 13W/M
- LED Lifetime: >36000h-L70 /B10-Ta25°C(LM-80/TM-21)
- CCT/CRI: 2700K/3000K/4000K , Ra90
- Input: 24V DC
- Dimming: 0-10V / DALI

Order Model

Model	LE D	Length	CR I	CC T	Series	Finish
HLSE Hard strip light	06 6W/M 10 10W/M 13 13W/M	10 1010mm	9 90	27 2700K 30 3000K 40 4000K	A3 Width: 17mm Height: 15mm	SG

Example: HLSE-0610-927A3SG

* Only white light specifications are supported, and the wires come out of the bottom quick connector

* For additional power, color temperature and length, please consult WAC

Accessories

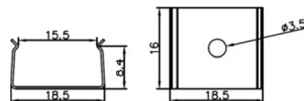

Dedicated fixed fixtures for the A3 series
2pcs/meter is included by default

HLSE A SERIES

Linear Luminaires

WAC ARCHITECTURAL

PROJECT:

TYPE:

Product Image



Line Drawing

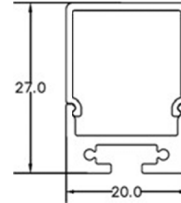

Product Description

HLSE-A4 line light, width 20mm, height 27mm, light on three sides, uniform light output without light spots, Ra>90, with high color reproduction, double-ended bottom quick connector, easy and quick to use with mounting clips. It is specially designed for indoor places such as small dark grooves, hook edge decoration, and luminous ceilings, and is suitable for hotel villas, commercial spaces, public venues and other places.

Product Features

- Main Material: Flexible copper FPCB board, high quality aluminum material, PC shade
- IP Rating: IP20
- Operating Temperature: -20°C~50°C

Product Specifications

- LED Type: SMD
- Source Power: 6W/M, 10W/M, 13W/M, 17W/M
- LED Lifetime: >36000h-L70 /B10-Ta25°C(LM-80/TM-21)
- CCT/CRI: 2700K/3000K/4000K , Ra90
- Input: 24V DC
- Dimming: 0-10V / DALI

Order Model

Model	LED	Length	CRI	CCT	Series	Finish
HLSE Hard strip light	06 6W/M	10 1010mm	9 90	27 2700K	A4 Width: 20mm Height: 27mm Light on three sides	SG
	10 10W/M			30 3000K		
	13 13W/M			40 4000K		
	17 17W/M					

Example: HLSE-0610-927A4SG

* The wires come out of the bottom quick connector

* For additional power, color temperature and length, please consult WAC

Accessories

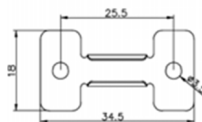

Dedicated fixed fixtures for the A4 series
2pcs/meter is included by default

HLSE A SERIES

Linear Luminaires

WAC ARCHITECTURAL

PROJECT:

TYPE:

Product Image



Line Drawing

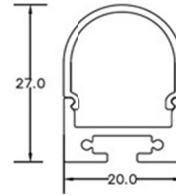

Product Description

HLSE-A5 line light, width 20mm, height 27mm, light on curved surface, uniform light output without light spots, Ra>90, with high color reproduction, double-ended bottom quick connector, easy and quick to use with mounting clips. It is specially designed for indoor places such as small dark grooves, hook edge decoration, and luminous ceilings, and is suitable for hotel villas, commercial spaces, public venues and other places.

Product Features

- Main Material: Flexible copper FPCB board, high quality aluminum material, PC shade
- IP Rating: IP20
- Operating Temperature: -20°C~50°C

Product Specifications

- LED Type: SMD
- Source Power: 6W/M, 10W/M, 13W/M, 17W/M
- LED Lifetime: >36000h-L70 /B10-Ta25°C(LM-80/TM-21)
- CCT/CRI: 2700K/3000K/4000K , Ra90
- Input: 24V DC
- Dimming: 0-10V / DALI

Order Model

Model	LED	Length	CRI	CCT	Series	Finish
HLSE Hard strip light	06 6W/M	10 1010mm	9 90	27 2700K	A5 Width: 20mm Height: 27mm Light on curved surface	SG
	10 10W/M			30 3000K		
	13 13W/M			40 4000K		
	17 17W/M					

Example: HLSE-0610-927A5SG

* The wires come out of the bottom quick connector

* For additional power, color temperature and length, please consult WAC

Accessories

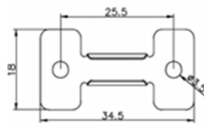

Dedicated fixed fixtures for the A5 series
2pcs/meter is included by default

HLSE A SERIES

Linear Luminaires

WAC ARCHITECTURAL

PROJECT:

TYPE:

Product Image



Line Drawing

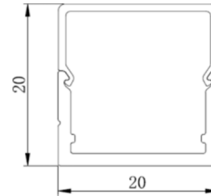

Product Description

HLSE-A6 line light, width 20mm, height 20mm, light on three sides, uniform light output without light spots, Ra>90, with high color reproduction, double-ended bottom quick connector, easy and quick to use with mounting clips. It is specially designed for indoor places such as small dark grooves, hook edge decoration, and luminous ceilings, and is suitable for hotel villas, commercial spaces, public venues and other places.

Product Features

- Main Material: Flexible copper FPCB board, high quality aluminum material, PC shade
- IP Rating: IP20
- Operating Temperature: -20°C~50°C

Product Specifications

- LED Type: SMD
- Source Power: 6W/M, 10W/M, 13W/M
- LED Lifetime: >36000h-L70 /B10-Ta25°C(LM-80/TM-21)
- CCT/CRI: 2700K/3000K/4000K , Ra90
- Input: 24V DC
- Dimming: 0-10V / DALI

Order Model

Model	LED	Length	CRI	CCT	Series	Finish
HLSE Hard strip light	06 6W/M	10 1010mm	9 90	27 2700K	A6 Width: 20mm Height: 20mm	SG
	10 10W/M			30 3000K		
	13 13W/M			40 4000K		

Example: HLSE-0610-927A6SG

* The wires come out of the bottom quick connector

* For additional power, color temperature and length, please consult WAC

Accessories



Dedicated fixed fixtures for the A6 series
2pcs/meter is included by default

HLSE A SERIES

Linear Luminaires

WAC ARCHITECTURAL

PROJECT:

TYPE:

Product Image



Line Drawing

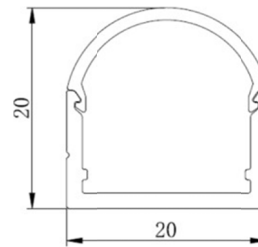

Product Description

HLSE-A6 line light, width 20mm, height 20mm, light on curved surface, uniform light output without light spots, Ra>90, with high color reproduction, double-ended bottom quick connector, easy and quick to use with mounting clips. It is specially designed for indoor places such as small dark grooves, hook edge decoration, and luminous ceilings, and is suitable for hotel villas, commercial spaces, public venues and other places.

Product Features

- Main Material: Flexible copper FPCB board, high quality aluminum material, PC shade
- IP Rating: IP20
- Operating Temperature: -20°C~50°C

Product Specifications

- LED Type: SMD
- Source Power: 6W/M, 10W/M, 13W/M
- LED Lifetime: >36000h-L70 /B10-Ta25°C(LM-80/TM-21)
- CCT/CRI: 2700K/3000K/4000K , Ra90
- Input: 24V DC
- Dimming: 0-10V / DALI

Order Model

Model	LED	Length	CRI	CCT	Series	Finish
HLSE Hard strip light	06 6W/M	10 1010mm	9 90	27 2700K	A7 Width: 20mm Height: 20mm Light on three sides	SG
	10 10W/M			30 3000K		
	13 13W/M			40 4000K		

Example: HLSE-0610-927A7SG

* The wires come out of the bottom quick connector

* For additional power, color temperature and length, please consult WAC

Accessories



Dedicated fixed fixtures for the A6 series
2pcs/meter is included by default