

## INVISILED indoor light strip ALED-TCE\* RGB sleeve light strip series

### Installation Precautions:

1. Please read through the Instructions before installation, **And carefully read the installation precautions;**
2. Although this product is a low-voltage product, please do not let children play with it;
3. Suitable for indoor installation and use (not suitable for wet location);
4. The ambient temperature for the use of LED strips is -20 °C -50 °C;
5. Make sure the power supply is cut off before installation and maintenance, to avoid the risk of electric shock.
6. When using a matching DC power supply, it is necessary to confirm the actual power consumption of the light strip, and then choose to use the corresponding power supply driver;
7. During the installation process, please pay attention to the polarity of the wiring and the working voltage requirements of the light strip;
8. The actual total power of the light strip cannot exceed 80% of the power of the connected power source;
9. It is recommended that the total length of the series connected light strip should not exceed 70W, otherwise the brightness difference between the head and tail will be significant. If necessary, please install it in parallel (as shown in the figure below);
10. During use, it is necessary to ensure that there is no cover of flammable and explosive materials;

| Power | Suggest connecting the maximum length in series |
|-------|---|
| 6W/M  | 11 M  |
| 12W/M | 5 M   |



### Wiring polarity

This type of product uses a 24V DC power supply, and the wiring method is shown in the polarity comparison table below.

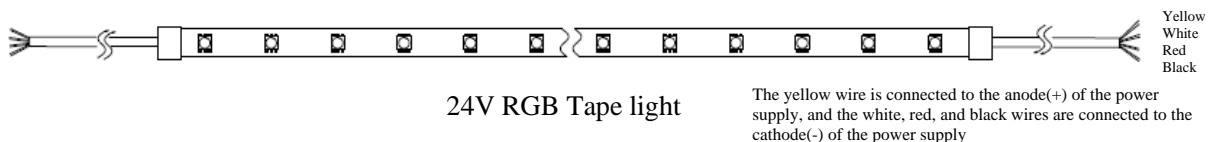

Polarity comparison table

| Color           | Anode(+)    | Cathode(-) |          |            |
|-----------------|-------------|------------|----------|------------|
|                 | Yellow wire | White wire | Red wire | Black wire |
| RGB light strip | 24+         | R          | G        | B          |

Licensed by "WAC" trademark holder - WAC LIGHTING, USA  
 Chinese Marketing Headquarters : WAC Lighting (Shanghai) Co, Ltd.  
 Address : 14, Lane 299, Bi Sheng Road, Shanghai 201204, China  
 China factory : Manufactured WAC Lighting (Dongguan) Co, Ltd.  
 Address : 390, Qingfeng Road, Qingxi Town, Dngguan, Guangdong. Postal code: 523653

## Installation method

### Splicing method:

When splicing the light strip with the light strip, in order to ensure even light output from the light strip, the tail of the sleeve should be stacked or staggered to ensure the same distance between the light beads, as shown in the following figure. When wiring, attention should be paid to polarity

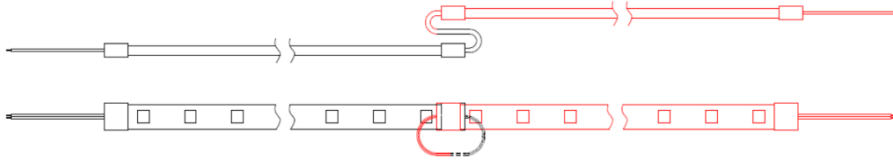

### A. Using installation tracks

-On a flat surface, such as wood.

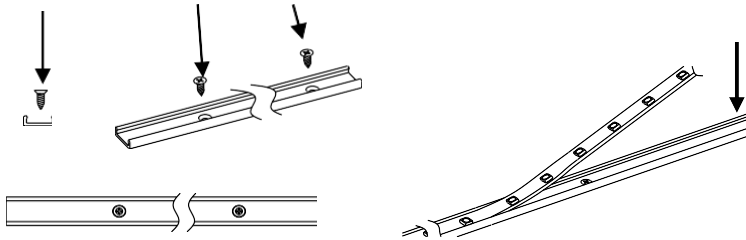

### B. Using installation clips

- Suitable for non flat installation surfaces, such as wood or concrete;
- There is space for two mounting screw holes on the installation surface;
- No edge contact installation requirements.

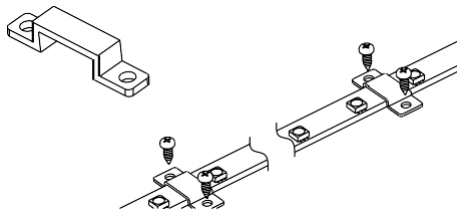

### C. Using installation clips

- Suitable for non flat installation surfaces, such as wood or concrete;
- Suitable for light strips two side contact installation.

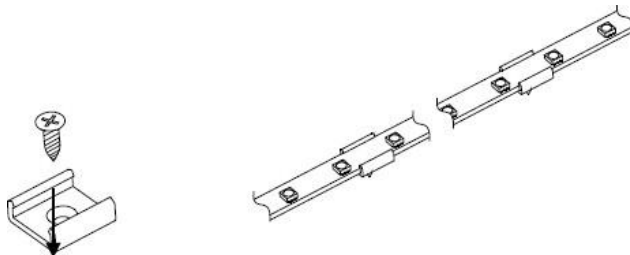

## Cropping instructions:

When cutting the light strip, please cut it at the "scissor position" on the light strip, otherwise it will cause the unit to not light up, and the cutting area needs to be covered with a tail plug for dust-proof and waterproof treatment. (As shown in the picture below)

After cutting the light strip, special tools are needed to continue the tail of the cut light strip. Please cut it carefully.

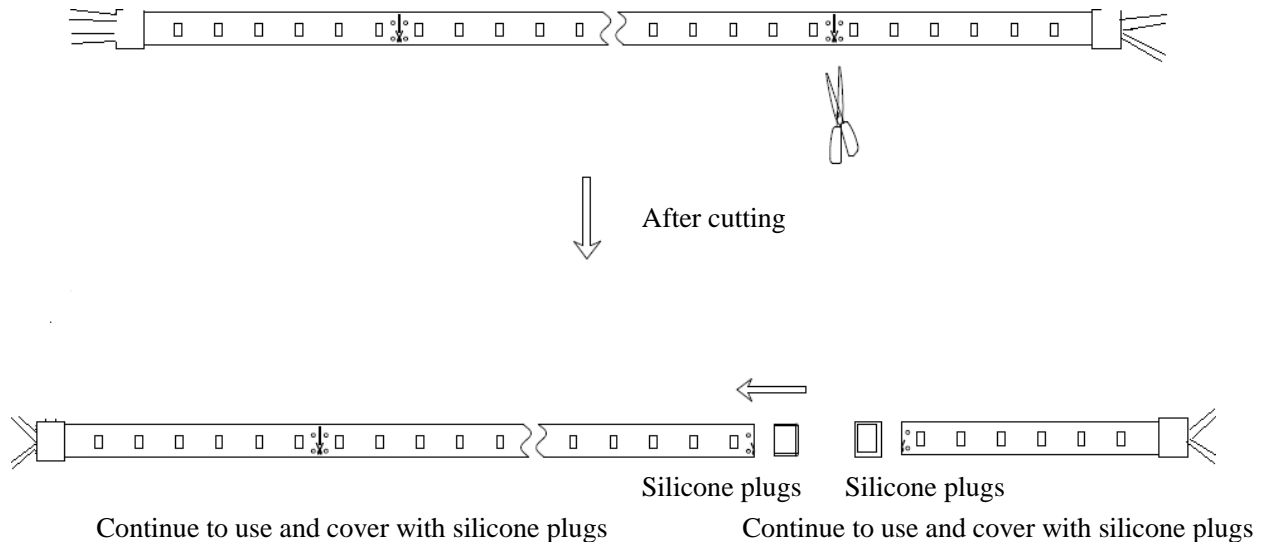

## Matters needing attention

1. Choose a track with the appropriate size, gently press the blank area between the lamp beads and the lamp strip track groove, and prohibit pressing or squeezing the lamp bead area from the front or side;
2. During the installation process, the bending radius of the light strip is greater than 30mm and cannot be forcefully bent at right angles. When taking the light strip during the installation process, it is prohibited to fold, twist, or forcefully twist it. If the light strip is damaged due to human factors or improper rail selection during the installation process, our company will not be responsible;



**Special attention: It is strictly prohibited to twist the light strip as shown in the diagram**

3. If the LED bead BIN area is selected for the identification of the light strip itself (using A, B, C, etc. identification), please pay attention to using the same BIN area identification of the light strip in the same area as much as possible during the installation process, so as to maintain the overall uniformity and uniformity of the light color of the light strip in the same area.